

Scala 1: 500

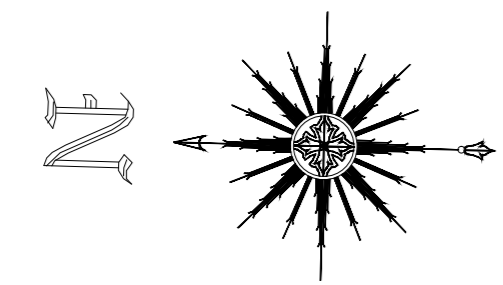

Esempi di stazioni del percorso Vitae

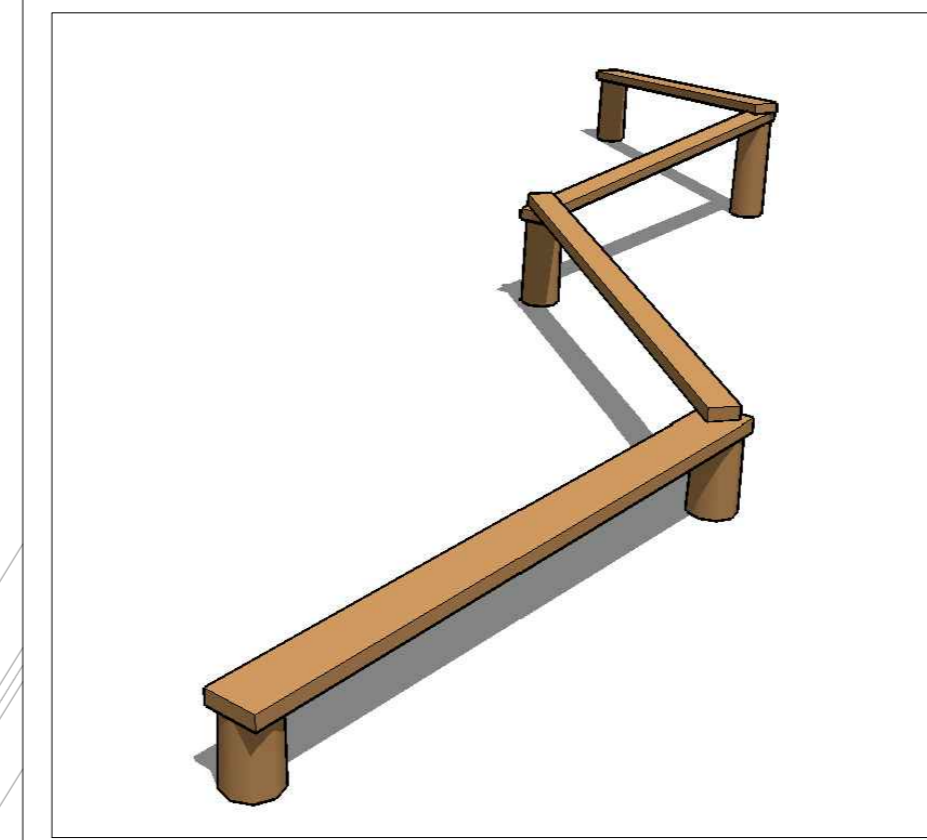

Assi di equilibrio

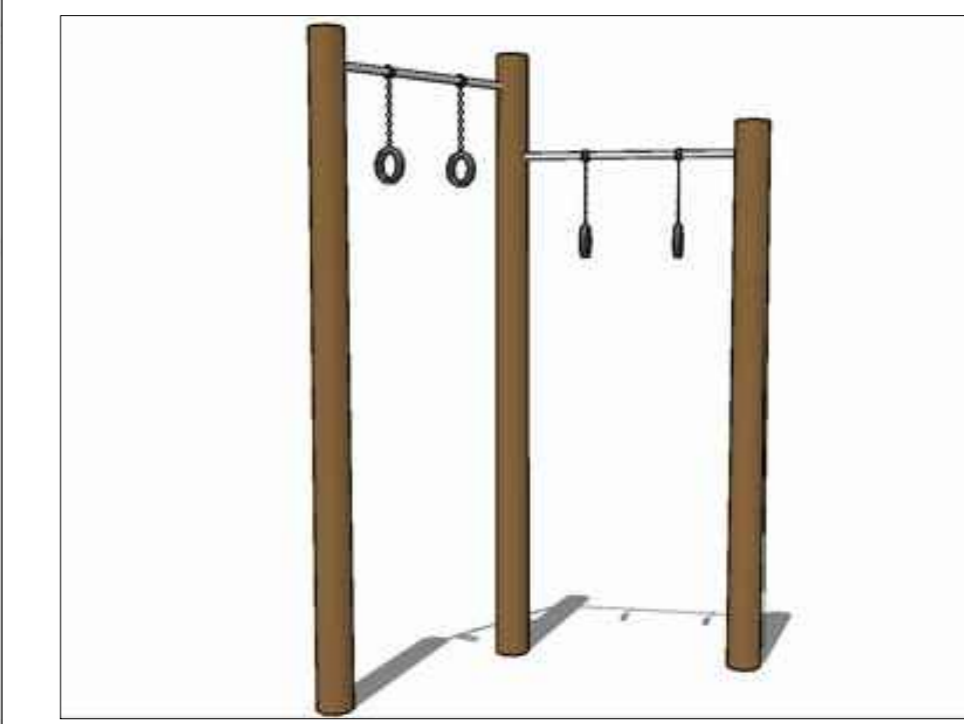

Anelli



Scala Orizzontale

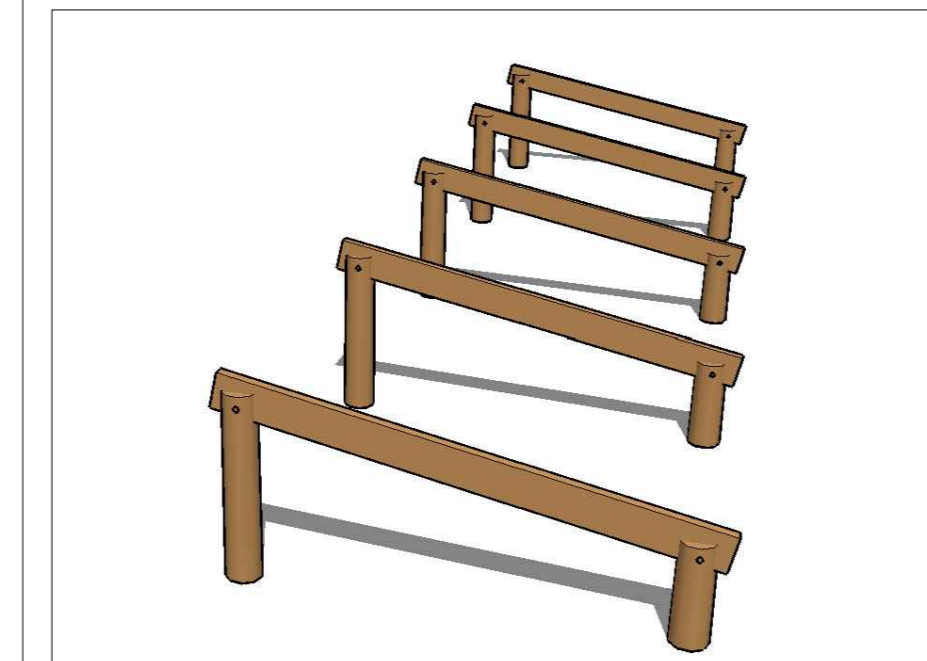

Salti

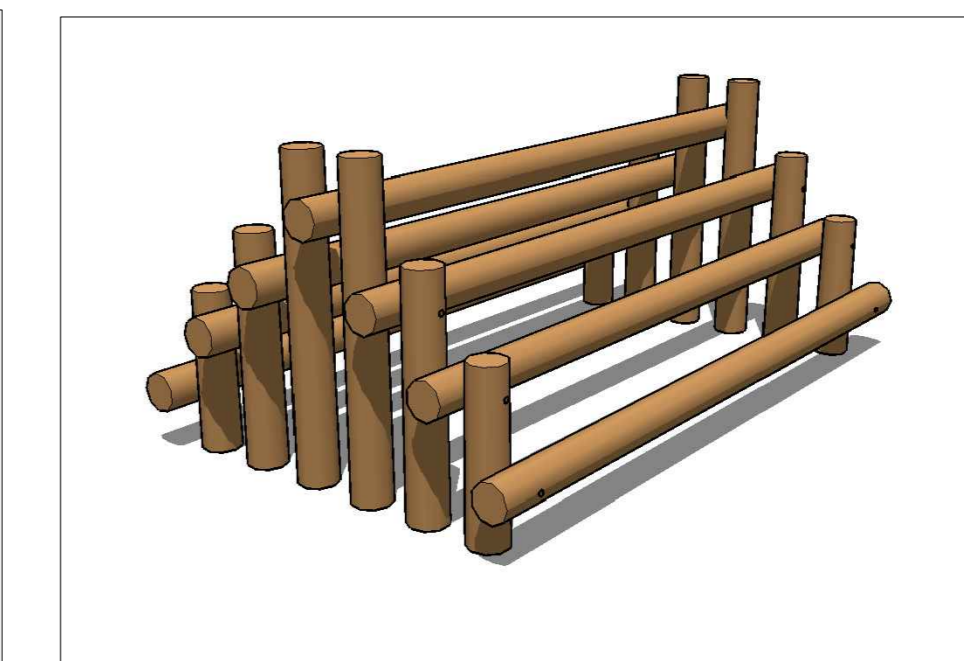

Scala sali-scendi

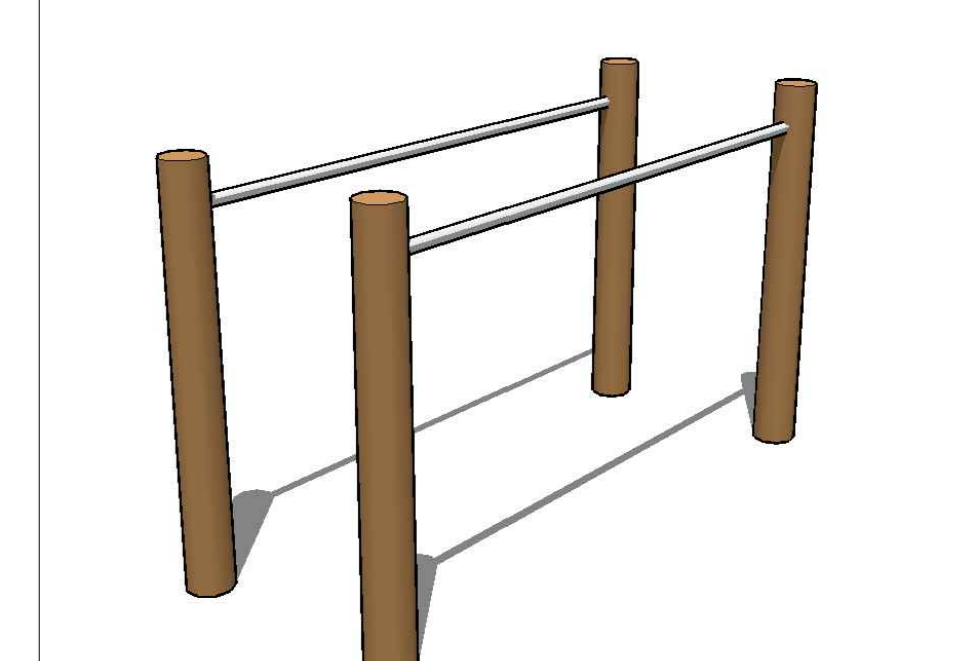

Parallele

Percorso Vitae

Legenda :

- 1 - Cavalletti
- 2 - Panca inclinata
- 3 - Scala orizzontale
- 4 - Spalliera con sbarre
- 5 - Anelli
- 6 - Salto
- 7 - Parallele
- 8 - Scala sali-scendi
- 9 - Sbarra
- 10 - Ponte oscillante
- 11 - Assi di equilibrio
- 12 - Flessione dorso

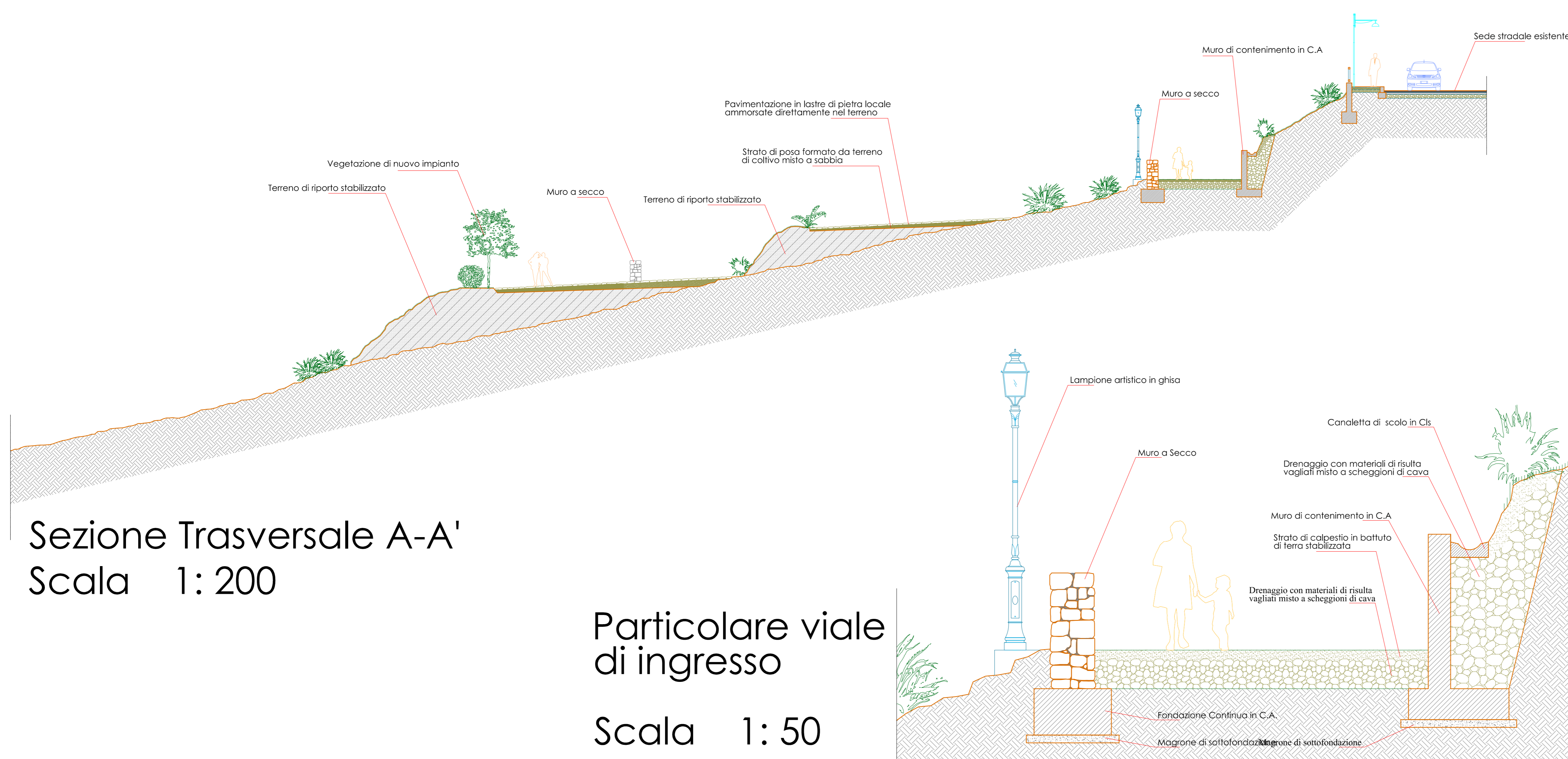
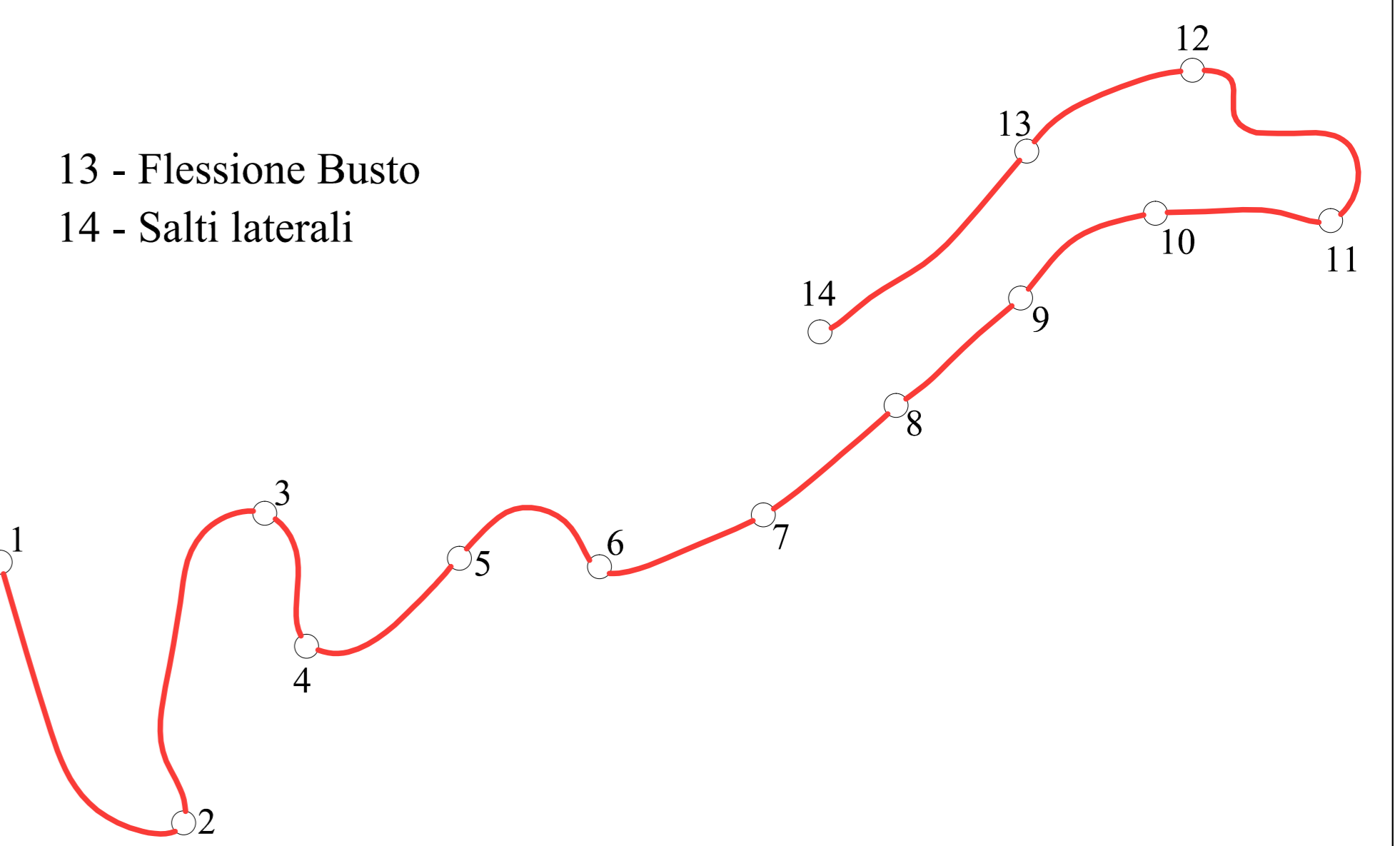

Sezione Trasversale A-A'
Scala 1: 200

Particolare viale di ingresso

Scala 1: 50

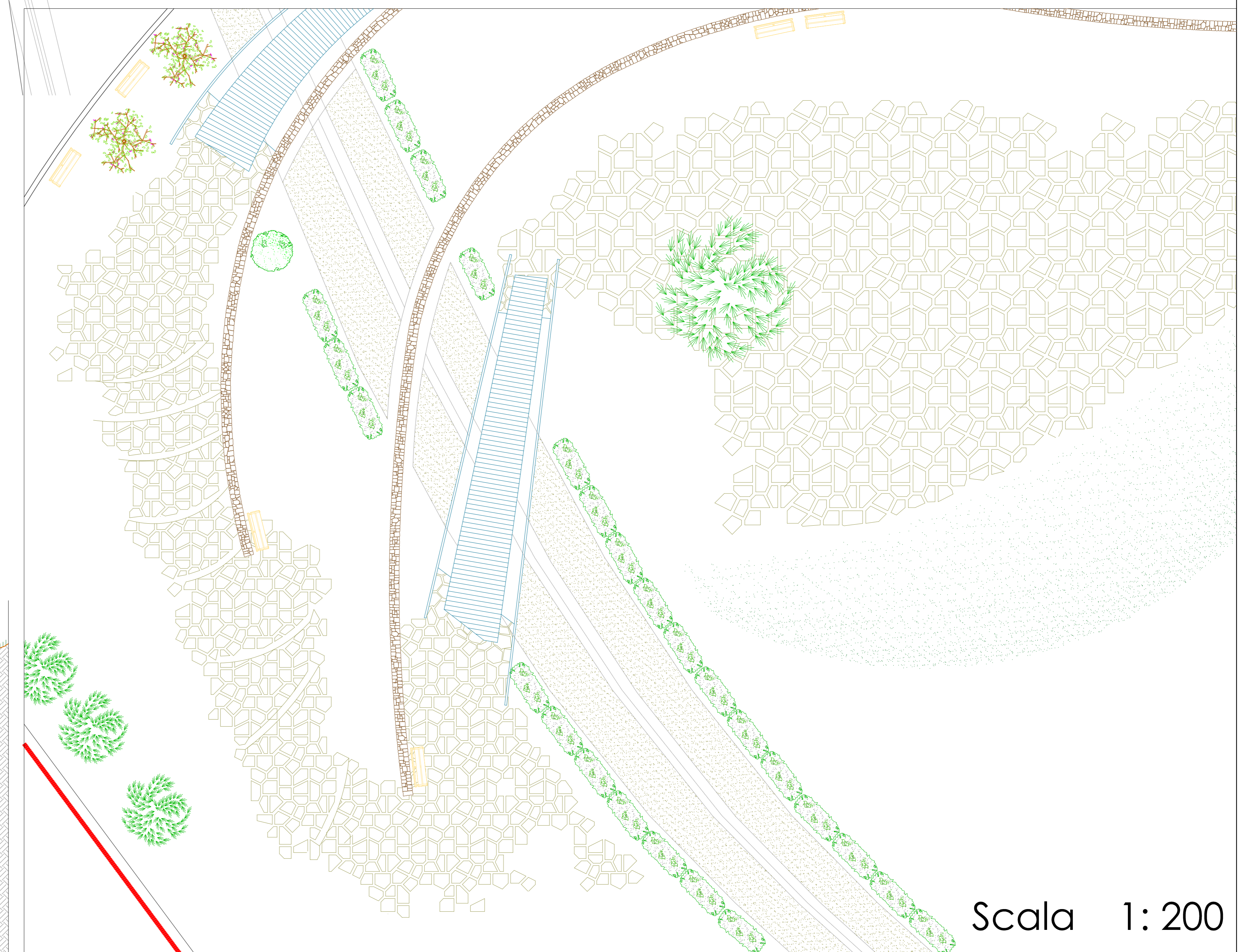

Scala 1: 200